



HOW TO INSTALL TPO CLAD DRIP EDGE METAL



» Purpose

To safely and correctly install TPO-clad drip edge metal at roof edges. This creates a clean, strong, watertight transition at the perimeter, while meeting Florida building code.

Why “TPO Drip Edge” (rather than cover tape)

- Seamless system all welded. Welds always beat tape.
- TPO-clad metal becomes part of the roof membrane. It is welded, not taped. Welds last longer than tape.
- No tape failures. Cover tapes can peel, shrink, or loosen over time—especially in Florida heat, UV, and wind. Welded TPO does not peel.
- TPO-clad drip edge resists wind uplift better than taped edges. Stronger in high winds due to screws rather than nails

Why the edge is important

The drip edge is the roof’s first line of defense at the edge. If it’s not tight, flat, and sealed, wind and water can get under the membrane. This is also one of the most common leak locations on flat roofs. A proper install gives the roof a clean look and long-lasting edge protection.



Cover tape failing on 5 year old TPO roof



TPO drip edge looks great and lasts as long as rest of roof

1

Install the Wood Nailer

- Install a wood nailer first. "Wood nailer" is just a piece of 2 by, 1 by or 1/2" wood (some times stacked together) that is installed along the edge for improved hold of screws at edges.
- This ensures screws hit solid wood the whole way through.
- The nailer must be straight, tight, and level with the roofs insulation.



2

Wrap first sheet of TPO over edge

- Run the first TPO sheet at least 2 inches past the roof edge
- Let the membrane hang straight and relaxed
- Make sure the sheet is square to the roof



3

Install the Drip Edge Metal

- Place the TPO drip edge tight against the roof edge **over first sheet of TPO**.
- Crimp it in by hand if needed so it fits snug and each piece is even with the next.
- **DONT overlap TPO drip edge. Butt it together and leave a very small gap so it can expand and contract.**
- Fasten with **flat pancake-head Phillips** screws every 4 inches on center.
- Use an impact driver so screws embed flush into the drip edge, **no raised heads**.



4

Weld the Unsupported TPO Strip

- Where two pieces of metal meet, butt the pieces with a small gap between them. Make sure they sit at even levels. Then weld a strip of unsupported TPO over the joint, **4" wide, down to bottom with corners rounded**.
- Set heat gun to around 6 for this step.
- This creates a seamless connection and prevents leaks at the seams.
- Take time on making this tight and straight, it will be visible from ground.
- It is important for project managers to educate client regarding finish look of this step.

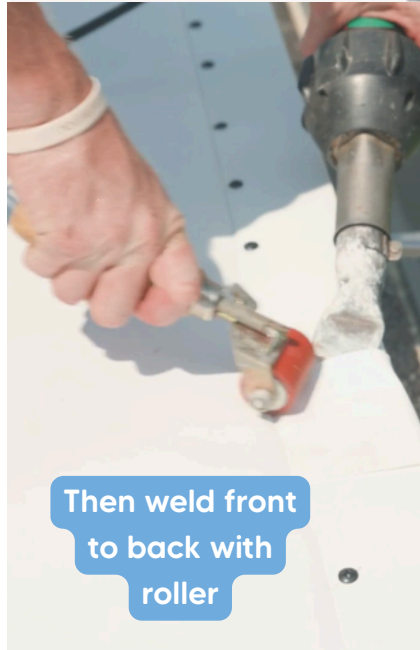
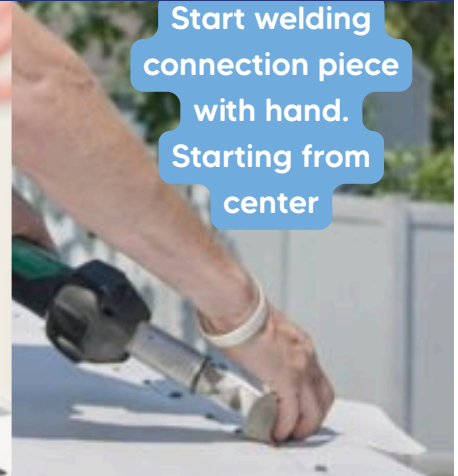

Project managers and sales team should always set expectations on final appearance, as it is different from a galvanized drip edge



Working together helps keep it tight to fascia as it is installed

5

Weld the Unsupported TPO Strip

- Cut and lay an 8-inch wide TPO strip over the drip edge.
- Tack it down with a hand welder.
- Create a small “air dam” bead with the hand welder before final welding. This prevents bubbles in the final weld and provides a backup waterproof bond.
- Complete the weld with the robot welder along both edges of the strip.
- Always perform a test weld first to confirm proper settings.



TIP: “Pulling Scrim”: An easy way to cut TPO straight. Helpful for strips like this, you are pulling a fiber from the TPO to create a straight line, here is how step by step:

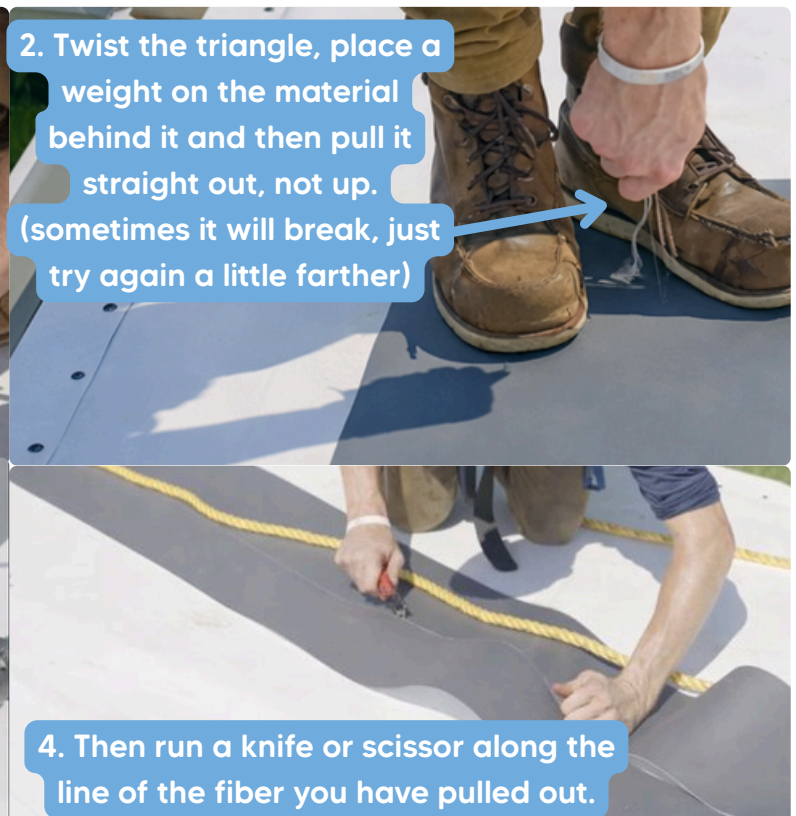
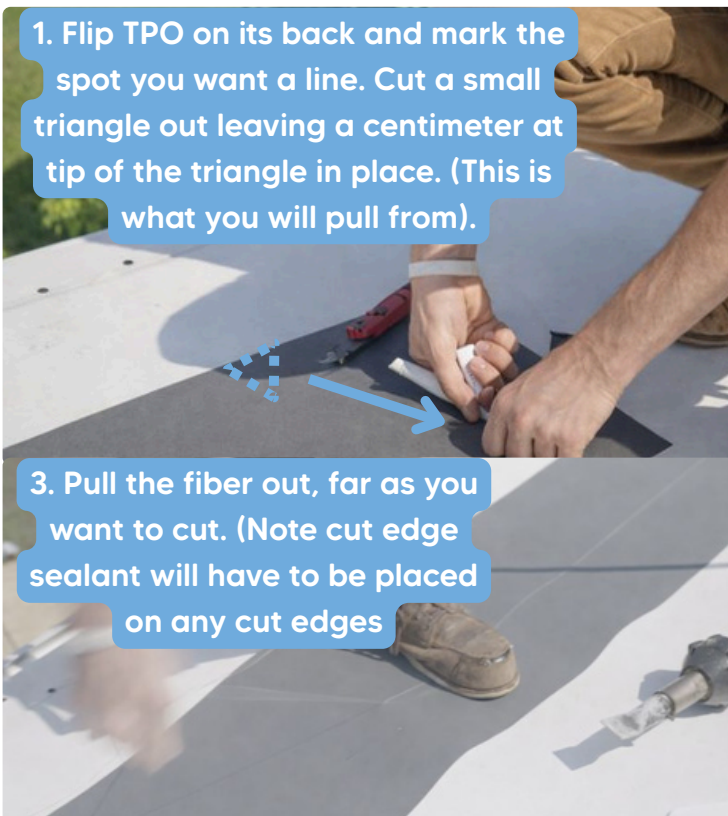

✗ What Not to Do

- Don't leave gaps between the drip edge and roof edge.
- Don't use the wrong screws—only pancake-head Phillips. Need to be flush under drip edge.
- Take your time on the unsupported TPO strips at metal joints, make them look great.
- Don't run the robot on edge without a test weld.



Final Checks:

Before moving on to the TPO install:

- ✓ Wood nailer installed solid as needed.
- ✓ Drip edge tight, screws every 4" OC, heads flush
- ✓ 8-inch cover strip welded with air dam and robot
- ✓ Probe seams to ensure water proof.



How to Install TPO Clad Drip Edge Metal

Scan Code for
Training Video

